

## Vollrath Soup Warmer Repair

---

- Instructions for repairing plunger on Vollrath Induction 7 Qt Drop In Well
  - *Wasserstrom item number 6040383/ Vollrath item number 74701DW*
- If plunger is damaged the item for repair is **6125695** found in the punchout



### Instructions for installation of plunger

---

Instructions for repairing plunger on Vollrath Induction 7 Qt Drop In Well

1. Unplug the cable of the plunger.



2. Remove four screws that secures the black base to the bottom of the soup well (on bottom of well), squeeze the tabs from the damaged plunger and push through to inside of well to remove.

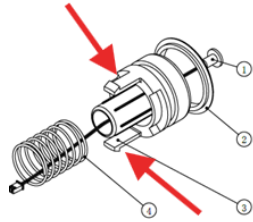

3. Place the new plunger in the hole from the top and (with the spring threaded through the cable) and connect the new cable to the existing cable.



4. Replace four screws to secure the base to the warmer.